

INSTRUCTION SHEET

OIL AND FILTER CHANGE PROCEDURE

OIL AND OIL FILTER CHANGE TABLE	
TRANSMISSION	OIL AND INTERNAL FILTERS CHANGE INTERVAL
WT SERIES (ON HIGHWAY)	AFTER FIRST 1,000KM (1,000 MILES) THEREAFTER, 40,000KM (25,000 MILES) OR 18 MONTHS, WHICHEVER OCCURS FIRST.
WT SERIES (OFF HIGHWAY)	AFTER FIRST 500 HOURS THEREAFTER, 1,000 HOURS OR 18 MONTHS, WHICHEVER OCCURS FIRST.

FILTER AND OIL REMOVAL

* IF ONLY FILTERS (3) ARE BEING REPLACED, DO NOT REMOVE DRAIN PLUGS (1 & 8) *

1) REMOVE DRAIN PLUG ASSEMBLY (1) AND (8)

2) REMOVE TWELVE BOLTS (7)

3) REMOVE TWO COVERS (6), TWO SEALS (4) **, TWO SEALS (5), AND TWO GASKETS (9) **

4) REMOVE TWO FILTERS (3)

* NOTE PLUG (8) IS ONLY USED ON 3070PT

** TWO SEALS (4) CAN BE EITHER O-RINGS OR SQUARE CUT SEALS. REPLACE WITH IDENTICAL SEALS.

** TWO GASKETS (9) ARE NOT USED ON EVERY TRANSMISSION- USE GASKETS ONLY IF REMOVED.

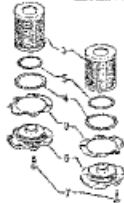
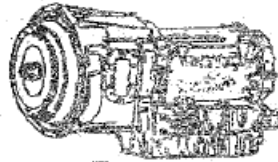
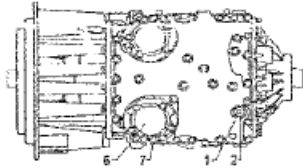

TRANSMISSION TYPE/ PARAMETER	LITERS	QUARTS
MD 3000R 300/B 400 - 4" SUMP		
INITIAL FILL	24.4	26
REFILL AFTER OIL CHANGE	14	15
MD 3000R 300/B 400 - 2" SUMP		
INITIAL FILL	18	19
REFILL AFTER OIL CHANGE	13	14
MD 3070PT - 7" SUMP		
INITIAL FILL	37	39
REFILL AFTER OIL CHANGE	30	32
MD 4000B 500 - 4" SUMP		
INITIAL FILL	45	48
REFILL AFTER OIL CHANGE	35	37
MD 4000B 500 - 2" SUMP		
INITIAL FILL	38	40
REFILL AFTER OIL CHANGE	28	30

APPROXIMATE QUANTITIES. AMOUNTS DO NOT INCLUDE COOLER AND EXTERNAL LINES.

FILTER AND OIL INSTALLATION

- 1) INSTALL TWO FILTERS (3) ON TWO COVERS(6).
- 2) INSTALL TWO COVERS (6), TWO SEALS(4) **, TWO SEALS (5), AND TWO GASKETS(9) **.
- 3) INSTALL TWELVE BOLTS (7): 51-61 NM (36-45 LB FT).
- 4) INSTALL DRAIN PLUG (1) AND O-RING (2) AND DRAIN PLUG (8) AND O-RING (2): 25-32 NM (18-24 LB FT).

- 1) OIL DRAIN PLUG 25-32NM (18-24 LBFT)
- 2) PACKING O-RING
- 3) FILTER
- 4) PACKING SEAL - REPLACE WITH IDENTICAL TYPE SEALS
- 5) PACKING SEAL
- 6) FILTER COVER
- 7) BOLT, M10 x 1.5 / SS, 51-61 NM (36-45 LBFT)
- 8) OIL DRAIN PLUG 25-32 NM (18-24 LB FT) NOT SHOWN
- 9) GASKET - USED ONLY IF REMOVED

